

NOTES

1. NO CUSTOMER REPLACEABLE PARTS.

2. MATERIAL:

BODY = BRASS

BALL = STAINLESS STEEL

SPRING = STAINLESS STEEL



3. OPENING PRESSURE = 65 PSI (448 kPa)
FULLY OPEN PRESSURE > 120 PSI (827 kPa)

4. WEIGHT = 1.3 OZ. (40.5 GRAMS)

5. DIMENSIONS IN [] ARE MILLIMETERS.

6. MAX. STATIC PRESSURE = 150 PSI
(1.03 MPa)

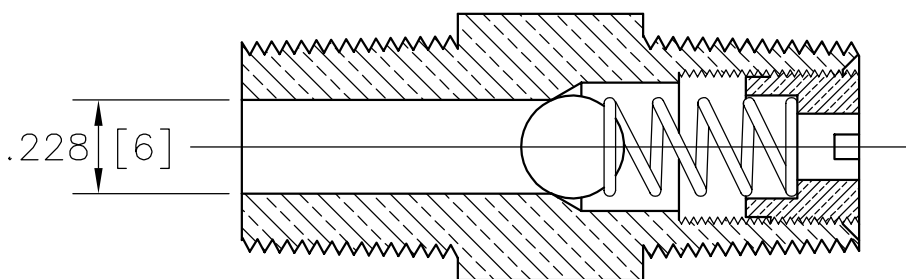

SECTION A-A



DRAWN BY: GPM		E.R.NO. 2496	
DATE: 12-12-86	CHKD. BY: KGM	APPD. BY: WH	
MODEL: PRV-70			
DRAWING NO. 55-02-0149		SIZE A	REV. C